

MM-C430

Micro Component Audio system
CD/MP3-CD/WMA-CD/CD-R/RW Playback
user manual

imagine the possibilities



Thank you for purchasing this Samsung product.
To receive more complete service,
please register your product at
www.samsung.com/register



Safety Warnings

ENG

TO REDUCE THE RISK OF ELECTRIC SHOCK, DO NOT REMOVE THE COVER(OR BACK).
NO USER-SERVICEABLE PARTS ARE INSIDE. REFER SERVICING TO QUALIFIED SERVICE PERSONNEL.

	CAUTION RISK OF ELECTRIC SHOCK DO NOT OPEN	
This symbol indicates "dangerous voltage" inside the product that presents a risk of electric shock or personal injury.	CAUTION : TO REDUCE THE RISK OF ELECTRIC SHOCK, DO NOT REMOVE COVER (OR BACK). NO USER SERVICEABLE PARTS INSIDE. REFER SERVICING TO QUALIFIED SERVICE PERSONNEL.	This symbol indicates important instructions accompanying the product.

WARNING

- To reduce the risk of fire or electric shock, do not expose this appliance to rain or moisture.
- To prevent injury, this apparatus must be securely attached to the floor/wall in accordance with the installation instructions.

CLASS 1	LASER PRODUCT
KLASSE 1	LASER PRODUKT
LUOKAN 1	LASER LAITE
CLASS 1	LASER APPARAT
PRODUCTO	LÁSER CLASE 1

CLASS 1 LASER PRODUCT

This product is classified as a CLASS 1 LASER product. Use of controls, adjustments or performance of procedures other than those specified herein may result in hazardous radiation exposure.

CAUTION

- Apparatus shall not be exposed to dripping or splashing and no objects filled with liquids, such as vases, shall be placed on the apparatus.

DANGER

VISIBLE AND INVISIBLE LASER RADIATION WHEN OPEN. AVOID DIRECT EXPOSURE TO BEAM. (FDA 21 CFR)

CAUTION

- CLASS 3B VISIBLE AND INVISIBLE LASER RADIATION WHEN OPEN. AVOID EXPOSURE TO THE BEAM (IEC 60825-1)
- THIS PRODUCT UTILIZES A LASER. USE OF CONTROLS OR ADJUSTMENTS OR PERFORMANCE OF PROCEDURES OTHER THAN THOSE SPECIFIED HEREIN MAY RESULT IN HAZARDOUS RADIATION EXPOSURE. DO NOT OPEN COVER AND DO NOT REPAIR YOURSELF. REFER SERVICING TO QUALIFIED PERSONNEL.

Note to CATV system installer

This reminder is provided to call the CATV system installer's attention to Section 820~40 of the NEC which provides guidelines for proper grounding and, in particular, specifies that the cable ground shall be connected to the grounding system of the building, as close to the point of cable entry as practical.

Important Safety Instructions

Read these operating instructions carefully before using the unit. Follow all the safety instructions listed below. Keep these operating instructions handy for future reference.

- 1). Read these instructions.
- 2). Keep these Instructions.
- 3). Heed all warnings.
- 4). Follow all instructions.
- 5). Do not use this apparatus near water.
- 6). Clean only with dry cloth.
- 7). Do not block any ventilation openings. Install in accordance with the manufacturer's instructions.
- 8). Do not install near any heat sources such as radiators, heat registers, stoves, or other apparatus (including amplifiers) that produce heat.
- 9). Do not defeat the safety purpose of the polarized or grounding-type plug. A polarized plug has two blades with one wider than the other. A grounding type plug has two blades and a third grounding prong. The wide blade or the third prong are provided for your safety. If the provided plug does not fit into your outlet, consult an electrician for replacement of the obsolete outlet.
- 10). Protect the power cord from being walked on or pinched particularly at plugs, convenience receptacles, and the point where they exit from the apparatus.
- 11). Only use attachment/accessories specified by the manufacturer.
- 12). Use only with the cart, stand, tripod, bracket, or table specified by the manufacturer, or sold with the apparatus. When a cart is used, use caution when moving the cart/apparatus combination to avoid injury from tip-over.
- 13). Unplug this apparatus during lightning storms or when unused for long periods of time.
- 14). Refer all servicing to qualified service personnel. Servicing is required when the apparatus has been damaged in any way, such as power supply cord or plug is damaged, liquid has been spilled or objects have fallen into the apparatus, the apparatus has been exposed to rain or moisture, does not operate normally, or has been dropped.



Precautions

ENG

- Ensure that the AC power supply in your house complies with the identification sticker located on the back of your product.
- Install your product horizontally, on a suitable base (furniture), with enough space around it for ventilation (3~4 inches).
- Do not place the product on amplifiers or other equipment which may become hot. Make sure the ventilation slots are not covered.
- Do not stack anything on top of the product.
- Before moving the product, ensure the Disc Insert Hole is empty.
- In order to disconnect the product completely from the power supply, remove the AC plug from the wall outlet, especially when left unused for a long period of time.
- During thunderstorms, disconnect the AC plug from the wall outlet. Voltage peaks due to lightning could damage the product.
- Do not expose the product to direct sunlight or other heat sources. This could lead to overheating and malfunction of the product.
- Protect the product from moisture, and excess heat or equipment creating strong magnetic or electric fields (i.e. speakers.).
- Disconnect the power cable from the AC supply if the product malfunctions.
- Your product is not intended for industrial use. Use of this product is for personal use only.
- Condensation may occur if your product or disc has been stored in cold temperatures. If transporting the product during the winter, wait approximately 2 hours until the product has reached room temperature before using.
- The batteries used with this product contain chemicals that are harmful to the environment. Do not dispose of batteries in the general household trash.

WHAT'S INCLUDED

Check for the supplied accessories below.

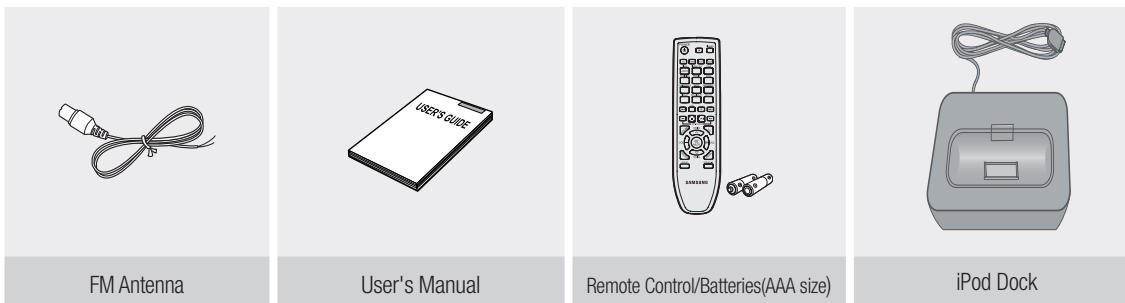

- • The accessories may look slightly different than those pictured above.

Contents

Thank you for buying this
SAMSUNG micro-compact system.

Please take time to read these instructions.
They will allow you to operate your
system with ease and take full advantage
of its features.

ENG

◆ SAFETY WARNINGS	2
■ Important Safety Instructions	3
■ Precautions	4
◆ INSTALLING YOUR MICRO-COMPACT SYSTEM	
■ Front Panel View	6
■ Top Panel View	6
■ Rear Panel View	7
■ Remote Control	7
■ Where to Install Your Micro-Compact System	8
■ Connecting your System to the Power Supply	8
■ Inserting Remote Control Batteries	8
■ Connecting the Loudspeakers	8
■ Connecting to an External Source	9
■ Connecting the FM Aerial	9
■ Connecting an iPod	10
■ Demo/Dimmer function	12
■ Setting the Clock	12
◆ CD/MP3/WMA-CD-PLAYER	
■ To play the CD/MP3/WMA-CD	13
■ Selecting a Track	13
■ Searching for a Specific Music Passage on a CD	13
■ Display Function	14
■ Function to skip through 10 track at a time	14
■ Remain Function	14
■ Repeating One or All Tracks on the Compact Discs	15
■ A-B Repeat Playback	15
■ Programming the Order of CD Playback	15
■ Checking or Changing Programmed CD Tracks	16
◆ USB	
■ Playing USB	16
■ To use high speed search	17
■ To repeat	17
■ Remain Function	17
■ To skip next 10 tracks	17
■ To repeat section	17
■ Selecting a Track from USB Device	17
◆ TUNER	
■ Searching for and Storing the Radio Stations	18
■ Selecting a Stored Station	19
■ Improving Radio Reception	19
◆ OTHER FUNCTIONS	
■ CD Ripping Function	20
■ Timer Function	21
■ Cancelling the Timer	21
■ Mute Function	22
■ Selecting EQ Mode	22
■ Treble Level Function	22
■ Bass Level Function	22
■ Power Sound Function	22
■ Power Bass Function	23
■ Setting the System to Switch off Automatically	23
■ Connecting Headphones	23
■ Connecting Microphone	23
◆ RECOMMENDATIONS FOR USE	
■ Safety Precautions	24
■ Cleaning Your Micro-Compact System	24
■ Precautions When Using Compact Discs	24
■ Before Contacting the After-Sales Service	25
■ Technical Specifications	26



Press



Push

Symbols



Important



Note

Front Panel View

ENG

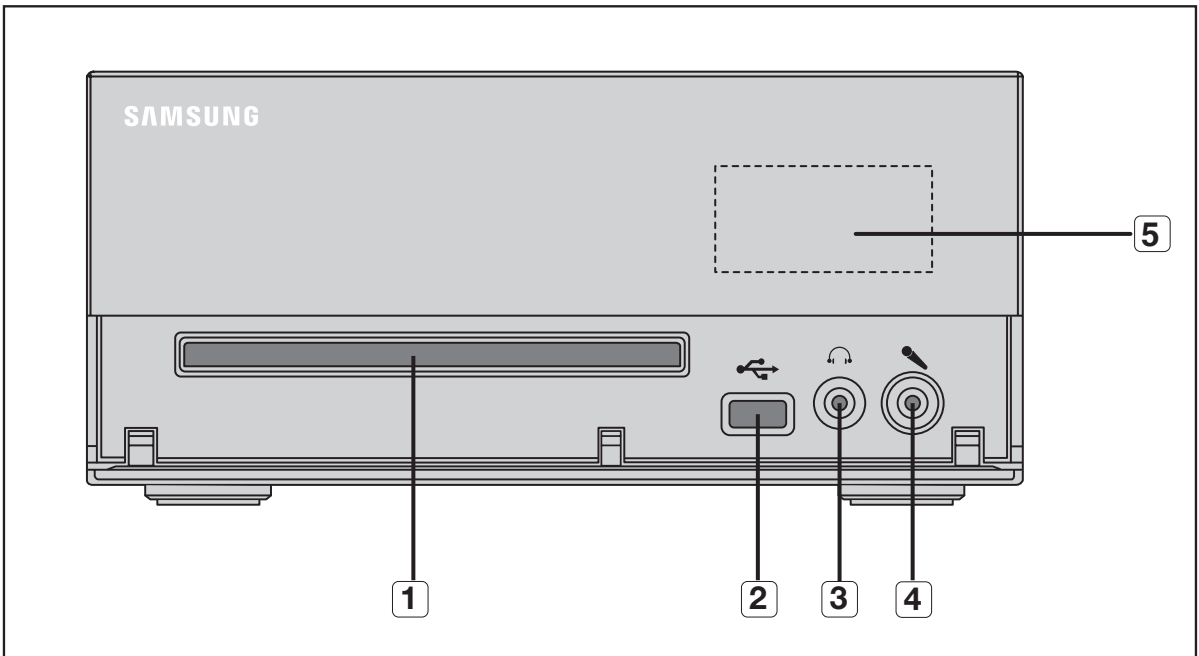

1. COMPACT DISC COMPARTMENT
2. USB JACK
3. HEADPHONE JACK
4. MIC JACK
5. WINDOW DISPLAY

Top Panel View

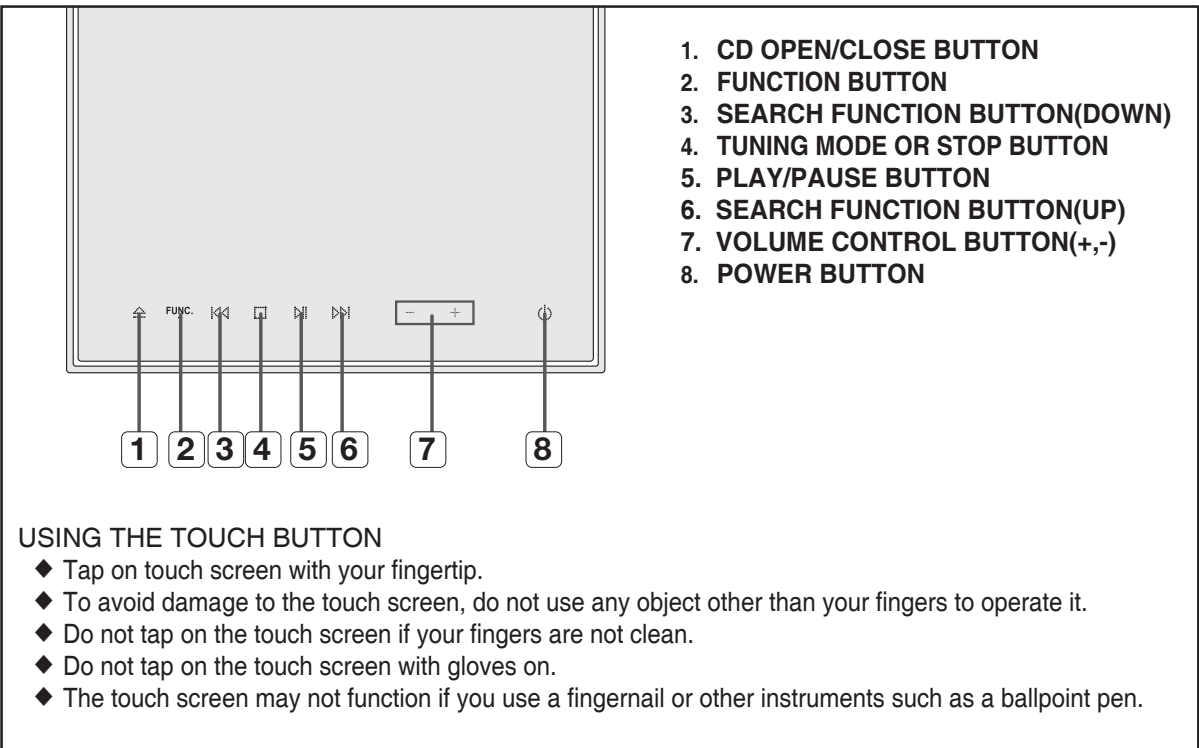

1. CD OPEN/CLOSE BUTTON
2. FUNCTION BUTTON
3. SEARCH FUNCTION BUTTON(DOWN)
4. TUNING MODE OR STOP BUTTON
5. PLAY/PAUSE BUTTON
6. SEARCH FUNCTION BUTTON(UP)
7. VOLUME CONTROL BUTTON(+,-)
8. POWER BUTTON

USING THE TOUCH BUTTON

- ◆ Tap on touch screen with your fingertip.
- ◆ To avoid damage to the touch screen, do not use any object other than your fingers to operate it.
- ◆ Do not tap on the touch screen if your fingers are not clean.
- ◆ Do not tap on the touch screen with gloves on.
- ◆ The touch screen may not function if you use a fingernail or other instruments such as a ballpoint pen.

Rear Panel View

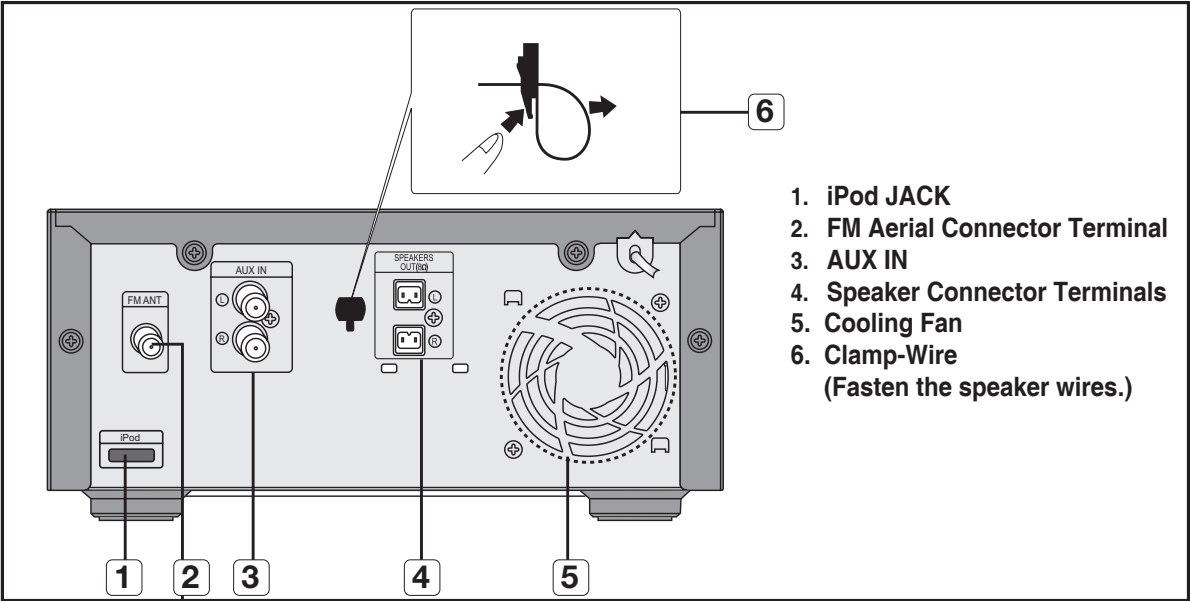

1. iPod JACK
2. FM Aerial Connector Terminal
3. AUX IN
4. Speaker Connector Terminals
5. Cooling Fan
6. Clamp-Wire
(Fasten the speaker wires.)

Remote Control

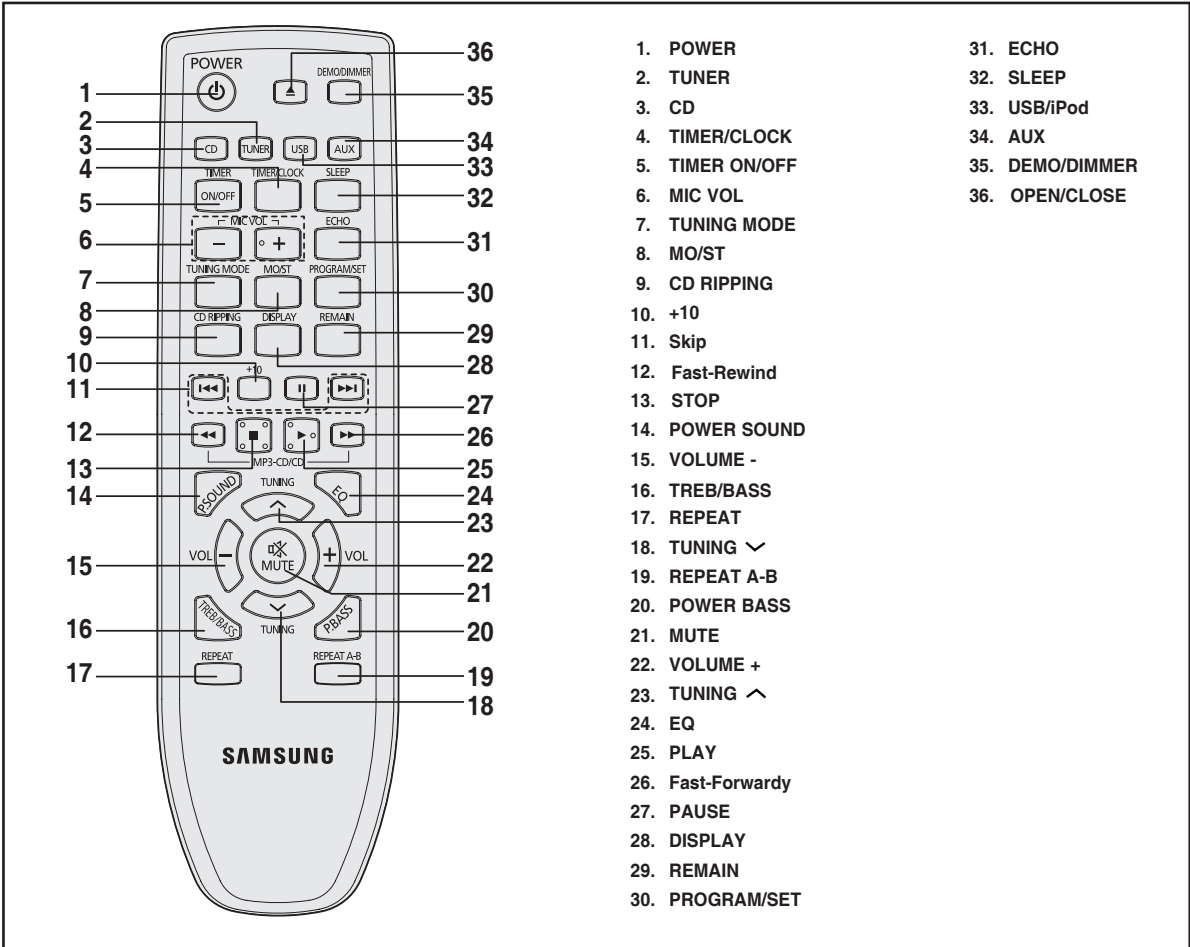

- | | |
|------------------|-----------------|
| 1. POWER | 31. ECHO |
| 2. TUNER | 32. SLEEP |
| 3. CD | 33. USB/iPod |
| 4. TIMER/CLOCK | 34. AUX |
| 5. TIMER ON/OFF | 35. DEMO/DIMMER |
| 6. MIC VOL | 36. OPEN/CLOSE |
| 7. TUNING MODE | |
| 8. MO/ST | |
| 9. CD RIPPING | |
| 10. +10 | |
| 11. Skip | |
| 12. Fast-Rewind | |
| 13. STOP | |
| 14. POWER SOUND | |
| 15. VOLUME - | |
| 16. TREB/BASS | |
| 17. REPEAT | |
| 18. TUNING ∨ | |
| 19. REPEAT A-B | |
| 20. POWER BASS | |
| 21. MUTE | |
| 22. VOLUME + | |
| 23. TUNING ∧ | |
| 24. EQ | |
| 25. PLAY | |
| 26. Fast-Forward | |
| 27. PAUSE | |
| 28. DISPLAY | |
| 29. REMAIN | |
| 30. PROGRAM/SET | |

Where to Install Your Micro-Compact System

To take full advantage of your new micro-compact system, follow these installation instructions before connecting the unit.

- ◆ Install the system on a flat, stable surface.
- ◆ Never place this unit on carpeting.
- ◆ Never place this unit in an outdoor area.
- ◆ Maintain an open space of approximately 6 inches (15 cm) on the sides and rear of the system, for ventilation purposes.
- ◆ Make sure that you have enough room to open the compact disc compartment easily.
- ◆ Place the loudspeakers at a reasonable distance on either side of the system to ensure good stereo sound.
- ◆ Direct the loudspeakers towards the listening area.
- ◆ For optimum performance, make sure that both speakers are placed at an equal distance above the floor.

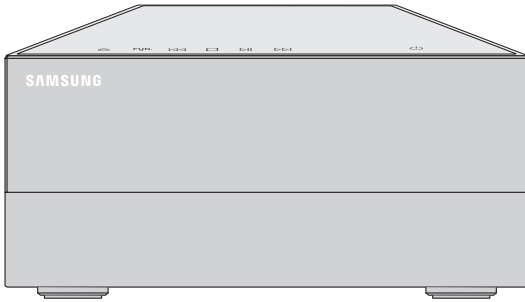

Connecting your System to the Power Supply

Before plugging your system into a main socket, you must check the voltage.

- 1 Plug the main lead into an appropriate socket.
- 2 Press the **⏻** (POWER) button to switch your micro-compact system.

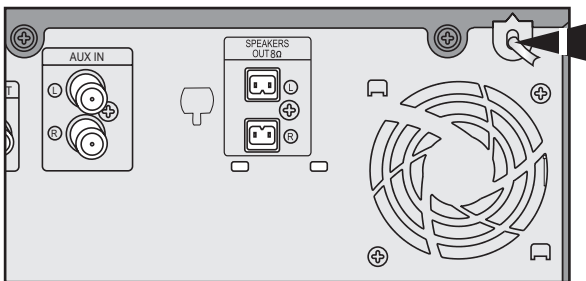

Inserting Remote Control Batteries

Insert or replace remote control batteries when you:

- ◆ Purchase the micro-compact system
- ◆ Find that the remote control is no longer operating correctly

When replacing the batteries, use a new set of batteries and never mix alkaline and manganese batteries.

- 1 Place your thumb on the position marked **▶** on the battery compartment cover (rear of the remote control) and pull the cover in the direction of the arrow.
- 2 Insert two AAA, LR03 or equivalent batteries, taking care to respect the polarities:
 - ◆ + on the battery against + in the battery compartment
 - ◆ - on the battery against - in the battery compartment
- 3 Replace the cover by sliding it back until it clicks into position.

- If you will not be using the remote control for a long time, remove the batteries to prevent corrosion.
- The remote control can be used up to approximately 7 meters (23 feet) in a straight line. It can also be operated at a horizontal angle of up to 30° from the remote control sensor.

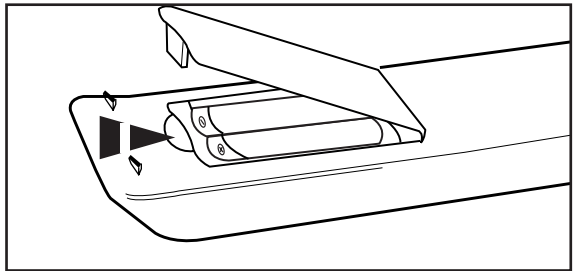

Connecting the Loudspeakers

The loudspeaker connector terminals are located on the rear of the system.

There are two terminals on the system:

- ◆ left speaker (marked L)
- ◆ right speaker (marked R)

To achieve the correct sound quality, insert those speaker connector cables to the speaker connector terminals of the system.

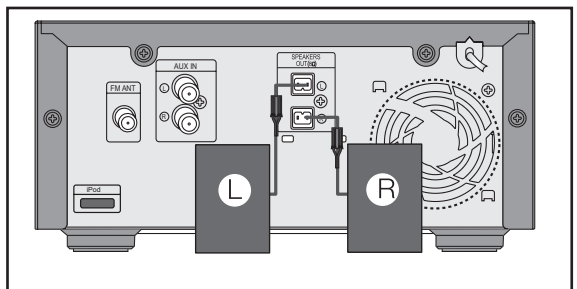

Connecting to an External Source

The auxiliary input can be used to take advantage of the sound quality of your micro-compact system when listening to other sources.

- Examples:
- ◆ A television
 - ◆ A DVD player
 - ◆ A VCR

➤ To connect to the external source, the source must have an audio output. In addition, you need a connection cable.

- 1 Set the system to standby mode and disconnect it and the external source from the main socket.
- 2 Connect the audio cable to the rear of the micro component system.
 - Be sure to match connector colors.
- 3 Plug the system back into the main socket and press **POWER** to switch it on.
- 4 Select the AUX source by pressing **AUX**.
Result: **AUX** is displayed.
- 5 Switch the external source on.
- 6 Adjust the volume and balance as required:
 - ◆ Volume
 - ◆ Equalizer

Example: You can watch a film and take advantage of stereo sound provided that the original sound track is in stereo (as if you were in a cinema).

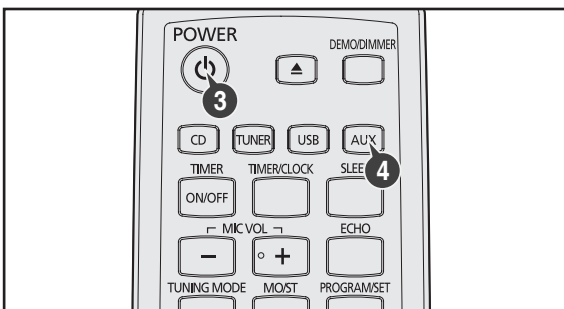
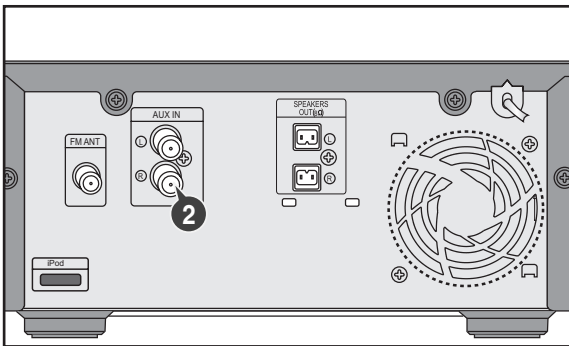

Connecting the FM Aerial

How to connect a COAXIAL TYPE aerial.

- ◆ Connect an antenna to the **FM** antenna terminal.
- ◆ Plug the connector on the **FM** aerial supplied into the coaxial socket marked **FM** on the rear of the system.
- ◆ Follow the instructions given on **Page 16** to tune into a radio station, and determine the best position for the aerial.
- ◆ If reception is poor, you may need to install an outdoor aerial.
To do so, connect an outdoor **FM** aerial to the **FM** socket on the rear of the system using a coaxial cable (not supplied).

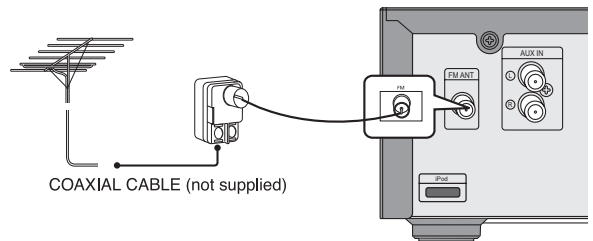
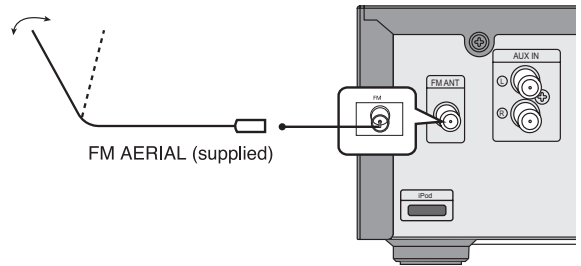

Connecting an iPod

ENG

You can listen to audio from an iPod through the main unit. For iPod operation with this Micro System, see this page and page 11.

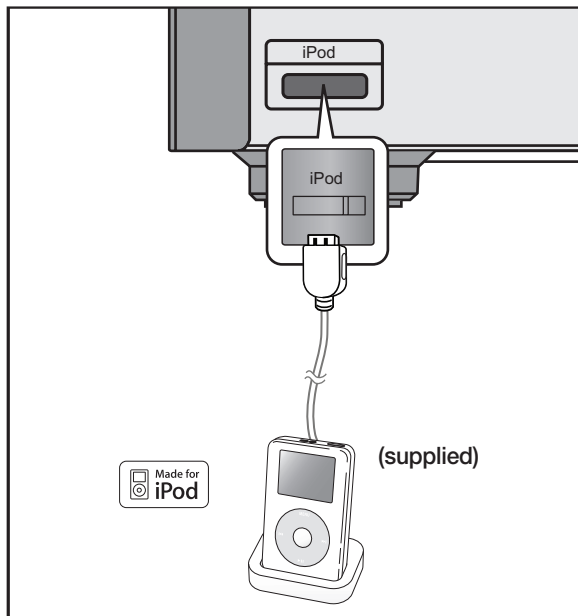

1. Connect the iPod dock connector to the iPod jack on the Micro System.
2. Press the USB button on the remote control to select IPOD to listen to music.
 - You can also use the FUNC. button on the main unit. The mode switches as follows : MP3/CD → TUNER → USB → IPOD → AUX.

- A iPod is for audio iPod.
- Depending on the type of iPod, you may need to insert one of the dock slots which are provided when you purchase the iPod. (see next page).
- Adjust the volume to a moderate level before you connect your iPod and Micro System.
- When the unit is powered on and you connect an iPod, the unit will charge your iPod's battery.

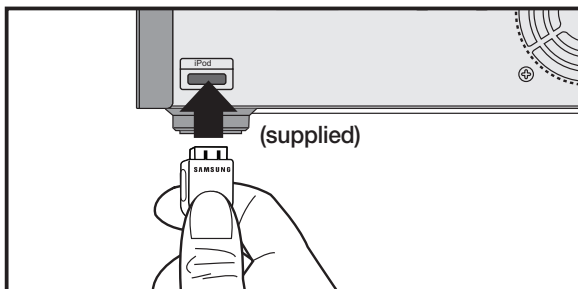

You can enjoy playback of your iPod using the supplied remote control.

Listening to Music (iPod function)







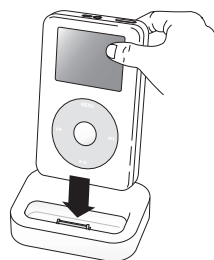





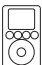

You can play music files stored in the iPod player by connecting it to the Micro Component system.

1. Connect the iPod dock connector to the iPod jack on the Micro System.
2. Place the iPod in the Dock.
 - Your iPod is automatically turned on.
3. Press the **USB** button on the remote control to select **IPOD** mode.
 - If the iPod player is connected to the Micro System, each time you press the the **USB** button, it will be toggled in the order of **USB** → **IPOD**.
4. After connecting iPod, Audio clip of iPod is played automatically.
5. You can use the remote control or main unit to control simple playback functions such as **PLAY**, **PAUSE**, **STOP**, **⏮**, **⏭**, **⏪**, **⏩** and **REPEAT**.

☞ See page 11 for compatible iPods. Compatibility depends on the software version of your iPod.



iPod models that are available to MM-C430

 <p>iPod nano 1st+2nd generation 5GB 10GB 20GB</p>	 <p>iPod 5th generation(video) 30GB 60GB 80GB</p>	 <p>iPod 3rd generation 10GB 15GB 20GB 30GB 40GB</p>
 <p>iPod nano 2nd generation(aluminum) 2GB 4GB 8GB</p>	 <p>iPod mini 4GB 6GB</p>	 <p>iPod 4th generation 20GB 40GB</p>
 <p>iPod nano 3rd generation(video) 4GB 8GB</p>	 <p>iPod 4th generation (color display) 20GB 30GB 40GB 60GB</p>	 <p>iPod classic 80GB 120GB 160GB</p>
 <p>iPod touch 1st generation 4GB 16GB 32GB</p>	 <p>iPod nano 4th generation(video) 8GB 16GB</p>	 <p>iPod nano 1st generation 1GB 2GB 4GB</p>
 <p>iPod touch 2nd generation 8GB 16GB 32GB</p>	 <p>iPod touch 3rd generation 32GB 64GB</p>	 <p>iPod nano 5th generation 8GB 16GB 30GB 60GB 80GB</p>

- “Made for iPod” means that an electronic accessory has been designed to connect specifically to iPod and has been certified by the developer to meet Apple performance standards.
- Apple is not responsible for the operation of this device or its compliance with safety and regulatory standards.

iPod is a trademark of Apple Inc., registered in the U.S. and other countries.

DEMO/DIMMER function

All functions available on the system can be viewed on the display and the display's brightness can be switched between "on" and "off".

- 1 Press the **DEMO/DIMMER** button.
Result: All functions available on the system appear on the front panel display.
- Each of these are explained in detail in this guide. Please refer to the relevant section.
- 2 Press the **DEMO/DIMMER** button.
Result: The Dimmer function is selected and the display darkens.
- 3 Press the **DEMO/DIMMER** button once again to brighten the front panel display.
- A display brightness control can only be performed while the system power is on.

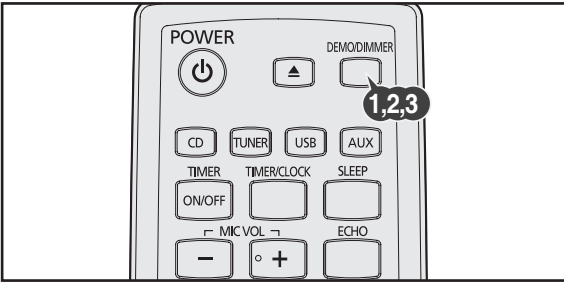

Setting the Clock

Your system is equipped with a clock which allows you to turn your system on and off automatically.

You should set the clock:

- ◆ When you first purchase the micro-compact system
- ◆ After a power failure
- ◆ After unplugging the unit

➤ ◆ For each step, you have a few seconds to set the required options. If you exceed this time, you must start again.

- 1 Switch the system on by pressing **POWER**.
- 2 Press **TIMER/CLOCK** twice.
Result: **CLOCK** is displayed.
- 3 Press **PROGRAM/SET**.
Result: The hour flashes.
- 4 **To...** **Press the TUNING button**
Increase the hours ^
Decrease the hours v
- 5 When the correct hour is displayed, press **PROGRAM/SET**.
Result: The minutes flash.
- 6 **To...** **Press the TUNING button**
Increase the minutes ^
Decrease the minutes v
- 7 When the correct time is displayed, press **PROGRAM/SET**.

- ◆ You can display the time, even when you are using another function, by pressing **TIMER/CLOCK** once.
- ◆ You can also use **⏪** or **⏩** buttons on the main unit to instead of **TUNING** button ^ or v in step 4, 6.

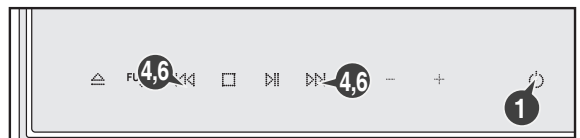
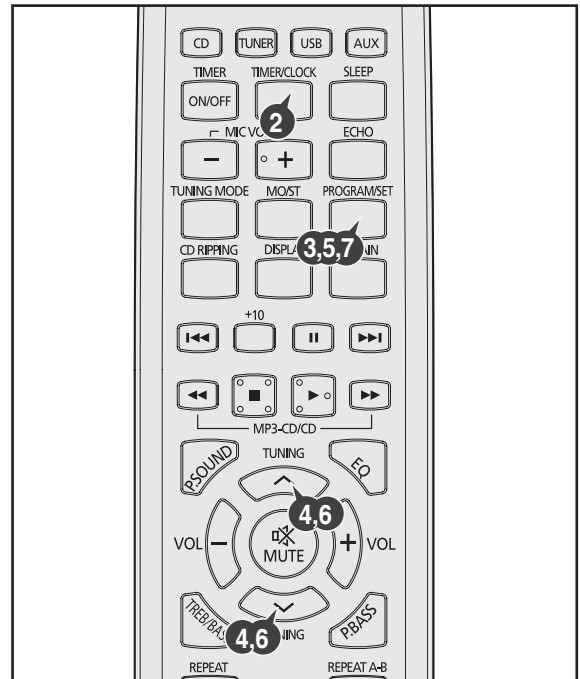

To play the CD/MP3/WMA-CD

You can play 5 inches or 3 1/2 inches compact disc without an adapter.

- You can play 5 inches or 3 inches compact discs without an adapter. This unit has been designed to playback the CD: Audio CD, CD-R, CD-RW and MP3/WMA-CD. Continued use of irregular shape CD (heart-shape, octagonal, etc.) can damage the unit.

- 1 Press the **FUNC.** button to select the CD function.
- 2 Press the Open/Close(☰) button.
Result: The compartment opens.
- 3 Place your disc in the compartment, with the label on the disc facing upwards.
- 4 Close the compartment by pressing the Open/Close(☰) button again.
- 5 Press the **PLAY/PAUSE**(▶||) button.
 - ◆ Your CD Player will take a few moments to scan through all the tracks recorded on a particular MP3/WMA-CD.
 - ◆ The English name of the song may be indicated on the display only if directly downloaded from the PC or if the purchased MP3/WMA-CD is sorted according to titles(directory). (Other languages besides English may not be indicated.)
 - ◆ The English name of the track may not be indicated depending on the characteristics of the MP3/WMA-CD.
- 6 Adjust the volume according to needs with the following procedures.
Press the **VOLUME** button of the main unit.
or
Press the **VOLUME+or -**button of the remote control. The volume level can be adjust in(VOL MIN,VOL 1- VOL 29,andVOL MAX).
- 7 **Main set:**
To pause playback temporarily, press the **PLAY/PAUSE**(▶||) button.
Press **PLAY/PAUSE**(▶||) again to continue playing the disc.
Remote control:
To pause playback temporarily, press the **PAUSE**(||) button.
Press **PLAY**(▶) button to continue playing the disc.
- 8 Press the **STOP**(□) button when you have finished.

- Press and hold **OPEN/CLOSE**(☰) button for 5 seconds, "LOCK" will be displayed and the compartment doesn't open. In this way you must press and hold **OPEN/CLOSE**(☰) button for a long time until "UNLOCK" will be displayed, the compartment can open.

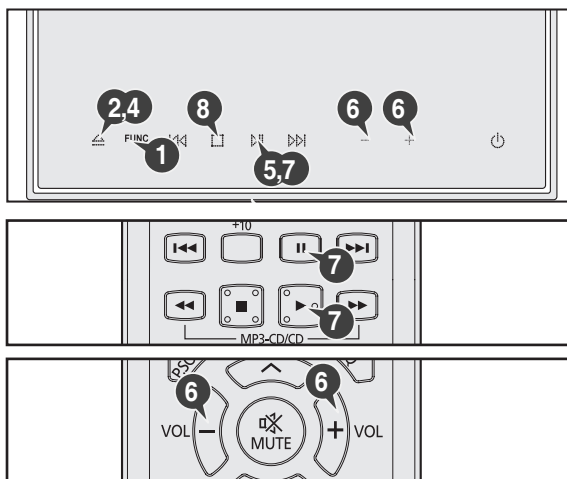

Selecting a Track

You can select the track you wish to listen to when a disc is playing.

To play the previous track

Press the **⏮** within 3 seconds after the current track started playing.
Press the **⏮** twice 3 seconds after the current track started playing.

To play the next track

Press the **⏭**.

To play the current track

Press the **⏮** 3 seconds after the current track started playing.

To play the track of your choice

Press the **⏮** or **⏭** the appropriate number of times.

- ◆ You can also use the **⏮** or **⏭** buttons on the remote control to select a track.

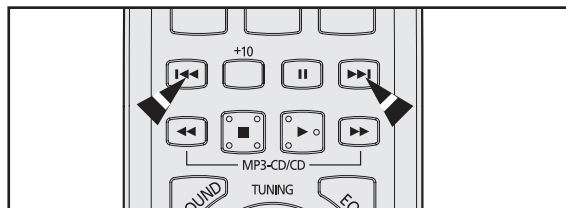
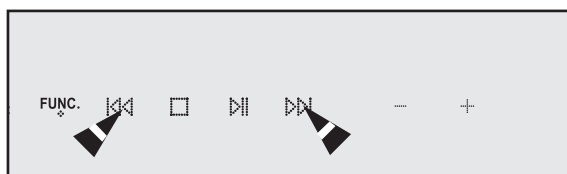

Searching for a Specific Music Passage on a CD

When listening to a compact disc, you can quickly search for a specific music passage on a track.

To search through the tracks... Press ...

Forwards **⏭**
Backwards **⏮**

- You can also press and hold down **⏮** or **⏭** on the main unit to auto search through the tracks.

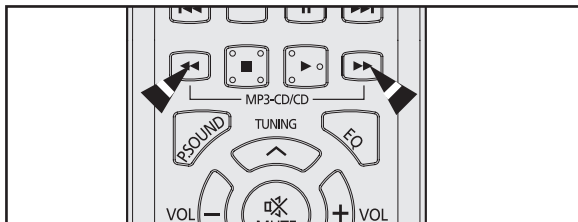

What is WMA?

WMA means Windows Media Audio, the global standard for audio signal compression technology.

What is MP3?

MP3 means MPEG1 Layer 3, the global standard for audio signal compression technology. It uses digital compression technology to compress original sound data by up to 12 times without sound quality degradation.

File Compatibility

- ◆ The unit will playback files created in MP3 format (Mpeg1, Layer3) with *.mp3 as their extension, and some WMA files with *.WMA extension can't be playback.
- ◆ Playback will be impossible for the file of MP2 or 22KHz.
- ◆ DTS-CD can not playback.

How many MP3 files can a CD-R or CD-RW disc record?

The maximum capacity of one CD-R or CD-RW disc is 680MB.

Normally, one MP3 file has a capacity of 4MB, therefore approximately 170 files can be recorded on a single disc.

Regarding the playback of CD-R/RW

- ◆ In the case of an original CD-R(Recordable) recorded in audio CD format, CD-RW(Rewritable) and editing by the user, playback is processed on the respective completed status. (The player may not be played back according to the characteristics of the CD or recorded status.)
- ◆ The CD-RW is comparably less reflexive than CD which causes more time delay to read.

Display Function

(This function is not available during playback of an MP3/WMA-CD.)

You may check the total tracks of the disc.

1 Press the DISPLAY button.

Result: The total tracks number of the disc is displayed, and it will be disappeared after 3 seconds.

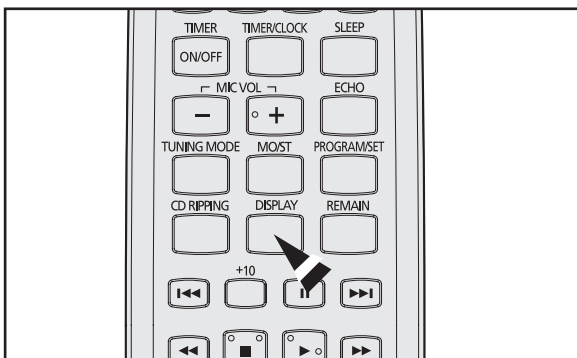

Function to skip through 10 tracks at a time

Press the +10 button briefly while playing back a CD and MP3/WMA-CD. The track 10 tracks after the current one will then be played back.

Example: If you want to select track 43 during playback of track 5, press the +10 button four times, and then press the ►► button three times.

5 → 10 → 20 → 30 → 40 → 41 → 42 → 43

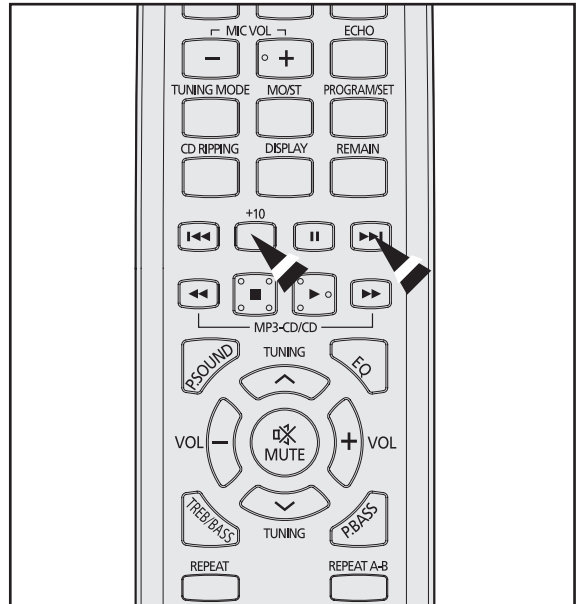

Remain Function

You can check the remaining time.

1 Press the REMAIN button.

- ◆ If you press the REMAIN button, the remaining time is displayed.

2 To cancel this function, press the REMAIN button again.

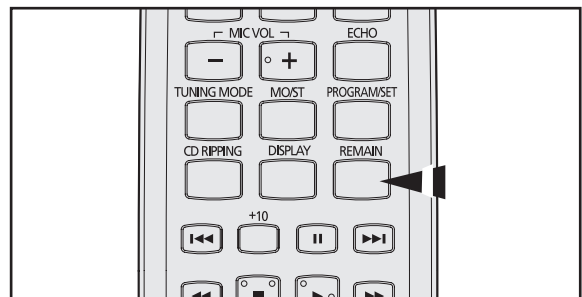

Repeating One or All Tracks on the Compact Discs

You can repeat indefinitely:

- ◆ A specific track on a compact disc.
- ◆ All tracks on the compact disc selected.

- Press REPEAT button.
Each time you press the REPEAT button, the repeat mode will change as follows:
MP3: RPT TRK → RPT DIR → RPT DISC → RPT SHF → RPT OFF.
CD: RPT TRK → RPT DISC → RPT SHF → RPT OFF.
- When you wish to stop the repeat function, press REPEAT until RPT OFF is displayed.
 - ◆ RPT TRK: Repeatedly plays the selected track.
 - ◆ RPT DIR: Repeatedly plays all tracks in the selected folder.
 - ◆ RPT DISC: Repeatedly plays the entire disc.
 - ◆ RPT SHF: Plays tracks in random order. (Each track can be played one time.)
 - ◆ RPT OFF: Cancels Repeat Playback.

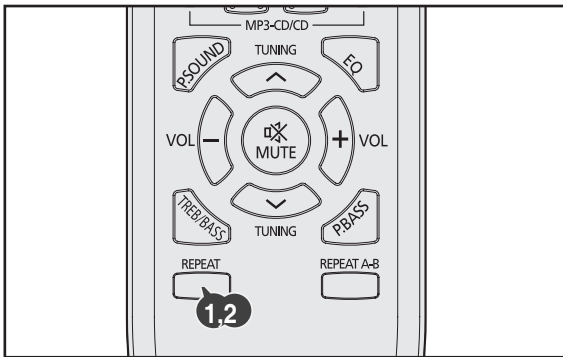

A-B Repeat Playback

You can repeatedly playback a designated section of a CD/MP3/WMA-CD.

- Press the REPEAT A-B button at the beginning of desired part.
◆ 'RPT A-' shows.
 - Press the REPEAT A-B button at the ending of desired part.
◆ 'RPT A-B' shows.
 - To cancel REPEAT A-B function, press REPEAT A-B button again.
- Point B cannot be set until 5 seconds of playback has elapsed from point A.

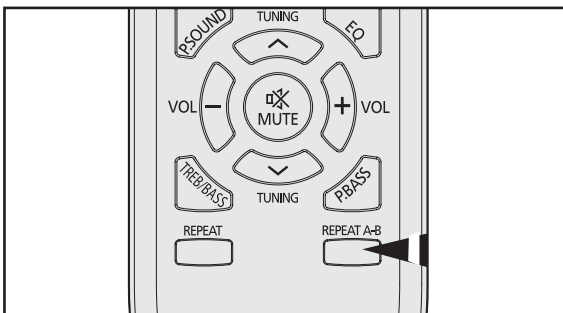

Programming the Order of CD Playback (This function is not available of an MP3/WMA-CD.)

You can decide:

- ◆ The order of the track desired to listen
- ◆ The track not desired to listen
- ◆ You can program up to 24 tracks.
- ◆ You must stop the compact disc player before selecting the tracks.

- If the CD function is selected, stop the player by pressing ■ .
- Press PROGRAM/SET.
Result: The following indications are displayed:
P601: --
(01 = Program no., -- = Track no. on the disc)
- Select the required track by pressing the ◀◀ or ▶▶ button:
 - ◆ Press the ◀◀ button to move back through the tracks.
 - ◆ Press the ▶▶ button to move forward through the tracks.
- Press PROGRAM/SET to confirm your selection.
Result: The selection is stored and *P602: --* is displayed.
- To select other tracks, repeat steps 3 to 4.
- Press PLAY (▶) to listen to the track selection in the order programmed.
- When press ■ button one time, compact disc player is stopped, and press ■ button again to cancel the selection.
 - ◆ If you open the compartment or turn off the power, the selection will be canceled.
 - ◆ If you select other functions, the selection will be canceled.

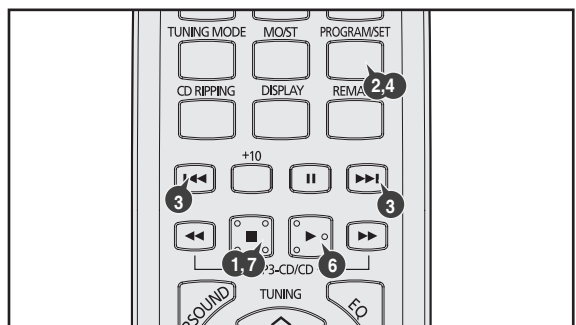

Checking or Changing Programmed CD Tracks

You can check or change your selection of tracks at any time.

- 1 Press **■** once if you have started listening to the selection.
- 2 Press **PROGRAM/SET**.
Result: The following indications are displayed:

CH01: 01

(CH = Check, 01=Program No., -- -- = Track No. on the disc)

➤ If you have already programmed 24 tracks, **CH** is displayed instead of **PG** when you press **PROGRAM/SET**.
- 3 Press **PROGRAM/SET** once or more times until the track to be changed is displayed.
- 4 Press **◀◀** or **▶▶** button to select a different track.
- 5 Press **PROGRAM/SET** to confirm your change.
- 6 Press **▶** to start listening to the selection.
Result: The first track selected is played.

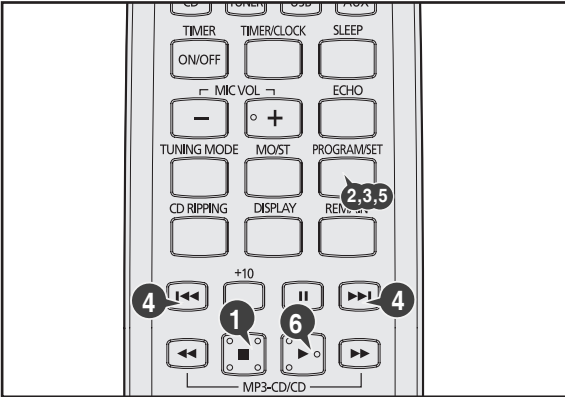

Playing USB

You can play MP3/WMA files by connecting to various external USB storage devices such as USB flash memory or HDD(Hard Disc drives).

- 1 Connect the external USB storage device to your player.
 - 2 Select USB function by pressing the **USB** button on the remote control.
or
Press the **FUNC.** button on the main unit to select USB function.
◆ The first track of the first directory plays automatically.
- **To stop playing**
Press the Stop (**■**) button to stop playing.

⚠ Do not connect a USB charging device to the USB connection port on the player, because it may cause damage to the product.

Please be aware of the following before using USB.

- ◆ Some external USB storage device may not be compatible with this player.
- ◆ With external HDD, FAT format can be played, however, the NTFS format can not.
- ◆ With USB 2.0 HDD, connect to a separate power source.
If it's not connected to a separate power source, it may not work.
- ◆ If memory of an external USB storage device is segmented into several parts, MP3 files of only the first hard disk drive can be played.
- ◆ DRM applied files are not played.
Digital Rights Management: Technology and service that protect the profit and rights of copyright owners by disallowing unauthorized use of digital contents.
- ◆ Even if the file name ends with .mp3, the file does not play if actual file format is MPEG layer 1 or 2.
- ◆ Do not use a USB hub as it will not be recognized.
- ◆ Up to 15 letters of MP3/WMA file name will be shown.
- ◆ Removable HDDs equipped with less than 160 Gbytes are supported.
Removable HDDs equipped with 160Gbytes or more may not be recognized, depending on the device.

Delay

- ◆ When selecting USB function, file reading (READ-IN) may take several minutes.
- ◆ When playing a USB device, there may be a delay then advancing to the next track, especially with HDD.
The operation time of external USB storage devices will vary; even when they are of the same capacity.
- ◆ If the external USB storage device supports only USB VER1.1 and the access speed is slow, the file may not property.

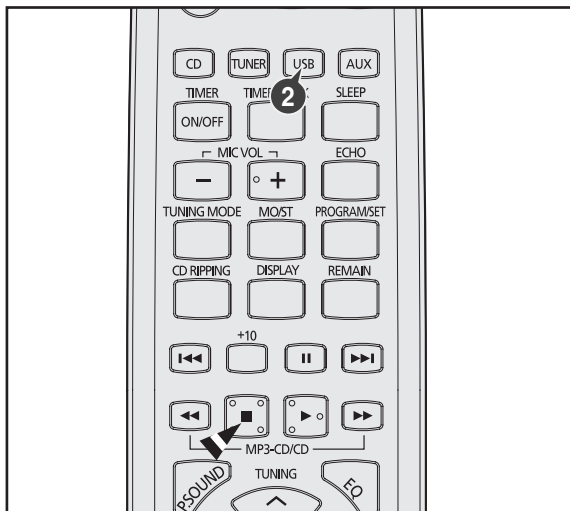
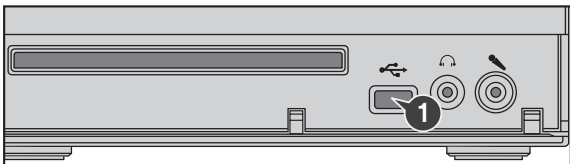

To use high speed search

- Before you begin!** ♦ Connect the external USB storage device to your player.
♦ Select USB function by using the USB button.

You can search the desired section quickly during the play

- Press the ◀◀, ▶▶ button.
♦ Whenever you press the button, you can search backward or forward quickly.
🔊 When you use the high speed search function, there is no sound.

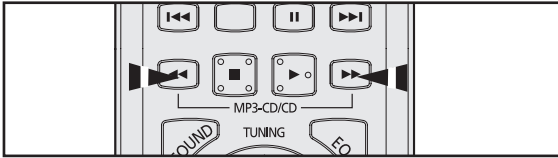

To repeat

- Before you begin!** ♦ Connect the external USB storage device to your player.
♦ Select USB function by using the USB button.

- Press REPEAT button.
Each time you press the REPEAT button, the repeat mode will change as follows:
RPT TRK → **RPT DIR** → **RPT ALL** → **RPT SHF** → **RPT OFF**.

When you wish to stop the repeat function, press **REPEAT** until **RPT OFF** is displayed.

- ♦ **RPT TRK**: Repeatedly plays the selected track.
- ♦ **RPT DIR**: Repeatedly plays all tracks in the selected folder.
- ♦ **RPT ALL**: Repeatedly plays all tracks.
- ♦ **RPT SHF**: Plays tracks in random order. (Each track can be played one time.)
- ♦ **RPT OFF**: Cancels Repeat Playback.

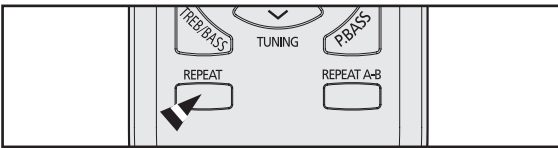

Remain Function

You can check the remaining time.

- Before you begin!** ♦ Connect the external USB storage device to your player.
♦ Select USB function by using the USB button.

- 1 Press the **REMAIN** button .
♦ If you press the **REMAIN** button, the remaining time is displayed.
- 2 To cancel this function, press the **REMAIN** button again.

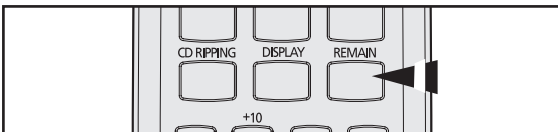

To skip next 10 tracks

- Before you begin!** ♦ Connect the external USB storage device to your player.
♦ Select USB function by using the USB button.

- Press the +10 button on the remote control shortly during the play.
Example: If you want to select 43rd track while 15th track is playing, press the +10 button 3 times, and then press the ▶▶ button 3 times .

15 → 20 → 30 → 40 → 41 → 42 → 43

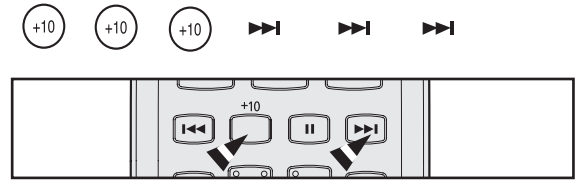

To repeat section

- Before you begin!** ♦ Connect the external USB storage device to your player.
♦ Select USB function by using the USB button.

- 1 Press the **REPEAT A-B** button at the beginning of desired part.
♦ 'RPT A-' shows.
 - 2 Press the **REPEAT A-B** button at the ending of desired part.
♦ 'RPT A-B' shows.
 - 3 To cancel REPEAT A-B function, press **REPEAT A-B** button again.
- Point B cannot be set until 5 seconds of playback has elapsed from point A.

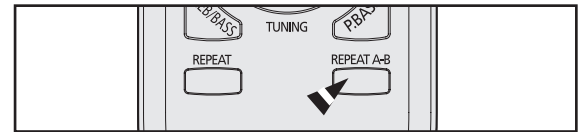

Selecting a Track from USB Device

You can select an MP3 file during the play.

- Before you begin!** ♦ Connect the external USB storage device to your player.
♦ Select the USB function by using the USB button.

- If you want to move the next/previous(track), press the ◀◀, ▶▶ button shortly.
♦ It moves the next/previous file within the directory.
♦ If you press the ◀◀, ▶▶ button more times than the number of the files in the directory, it will move over to the next directory.

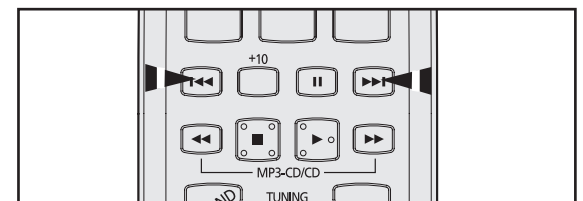

Searching for and Storing the Radio Stations

ENG

You can store up to:

- ◆ 15 FM stations

- 1 Switch the system on by pressing **POWER**.
 - 2 Select the TUNER function by pressing **TUNER** on the remote control.
or
Press the **FUNC.** button on the main unit to select the TUNER function.
-
- 3 To search for a station... Press TUNING MODE button**
- | | |
|---------------------|--|
| Preset | Once or more times until PRESET is displayed. |
| Automatically | Once or more times until AUTO is displayed. |
| Manually | Once or more times until MANUAL is displayed. |
- 4 Select the station to be stored by:
 - ◆ Pressing **TUNING** \wedge or \vee on the remote control.
 - ◆ To scroll through the frequencies faster when searching manually, hold down the \lll or \ggg buttons.
 - ◆ The automatic search procedure may stop on a frequency that does not correspond to a radio station. If this happens, use the manual search mode.
 - 5 Adjust the volume by:
 - ◆ Press the **VOLUME** button on the main unit
 - or
 - ◆ Pressing the **VOLUME +** or **-** buttons on the remote control
 - 6 Select the FM stereo or mono mode by pressing **MO/ST**.
 - 7 If you do not want to store the radio station found, revert to Step 3 and search for another station.
Otherwise:
 - a Press **PROGRAM/SET**.
 - b Press \lll or \ggg on the main unit or press **TUNING** \wedge or \vee on the remote control to assign a program number .
 - c Press **PROGRAM/SET** to store the radio station.
 - 8 To store any other radio frequencies required, repeat Steps 3 to 7.

➤ In Tuner mode

- ◆ In manual tuning mode, you can use \lll or \ggg button on the main unit to manual search a radio station.
- ◆ During Tuner auto searching, press \square button on the main unit or **TUNING MODE** button on the remote control to stop auto searching.
- ◆ In Preset tuning mode, you can use \lll or \ggg button on the main unit to search a stored radio station.

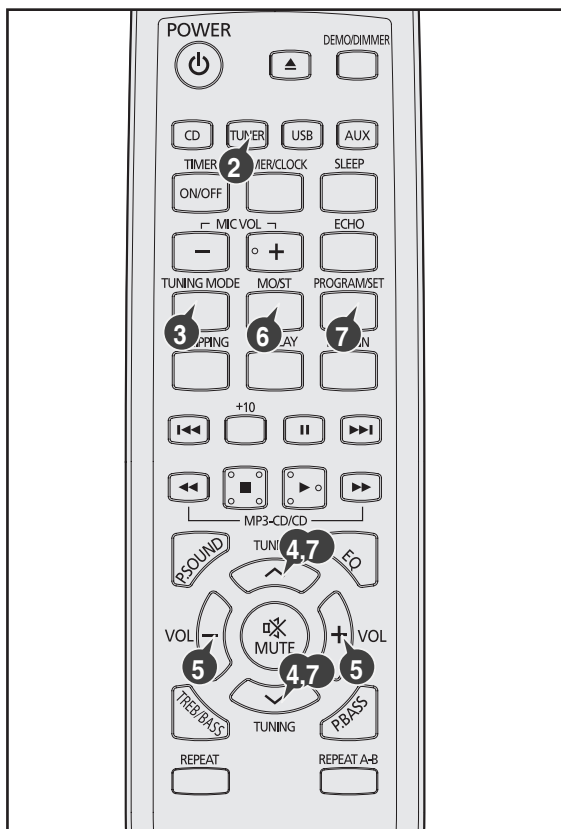
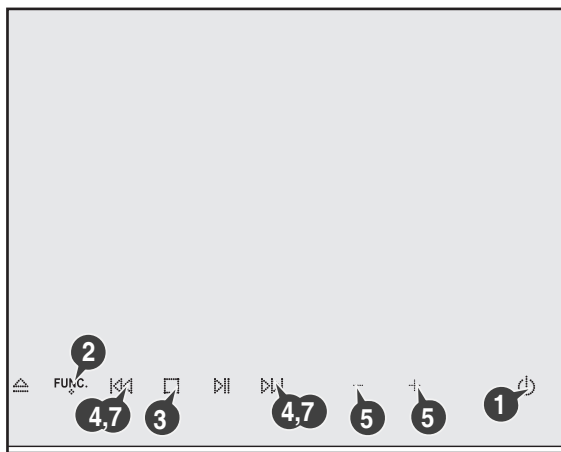

Selecting a Stored Station

You can listen to a stored radio station as follows:

- 1 Switch the system on by pressing **POWER**.
- 2 Select the **TUNER** function by pressing **TUNER** on the remote control.
or
Press the **FUNC.** button on the main unit to select the **TUNER** function.
- 3 Press the **TUNING MODE** button on the remote control or on the main unit until **"PRESET"** is displayed.
- 4 Press **⏮** or **⏭** to select the desired station.
or
Select the desired station by pressing the **TUNING** **▲** or **▼** button on the remote control.
Result: The desired station is now received.

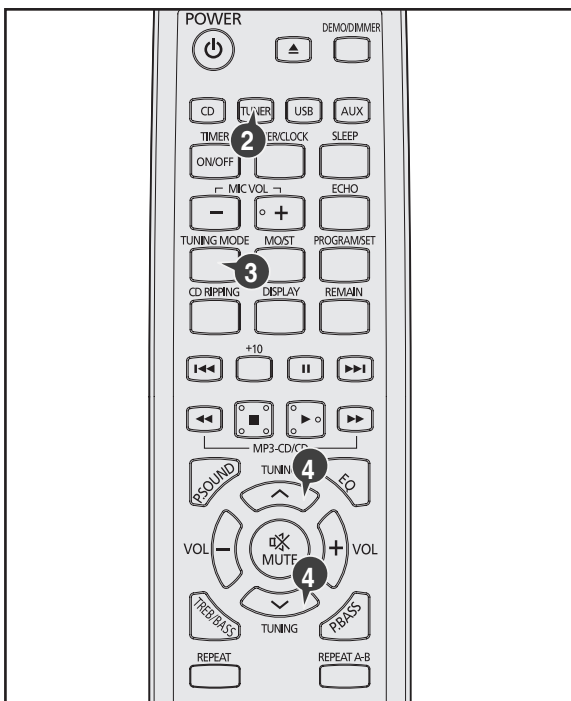
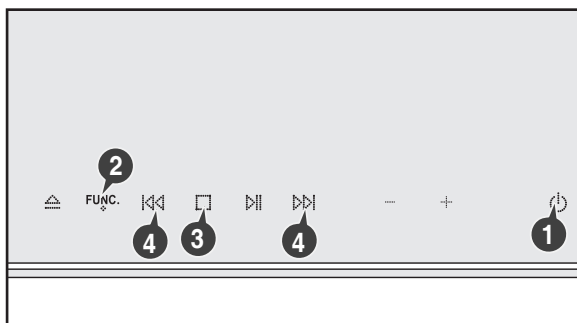

Improving Radio Reception

You can improve the quality of radio reception by:

- ◆ Rotating the FM aerial
- ◆ Testing the positions of the FM aerials before fixing them permanently

➤ If reception from a specific FM radio station is poor, press **MO/ST.** to switch from stereo mode to mono. The quality of the sound will be improved.

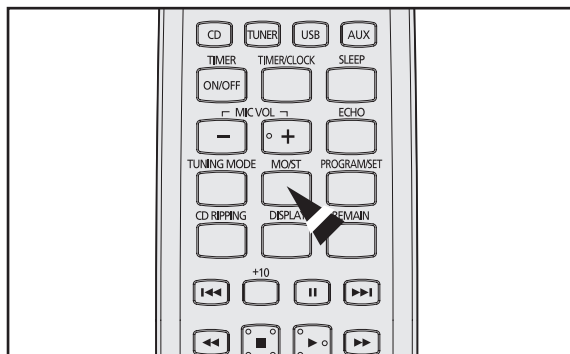

CD RIPPING Function

You can rip a compact disc as a MP3 file on the USB
This feature enables you to ripping with the start of the disc or track of your choice.

- 1 Switch the system on by pressing **POWER**.
- 2 Connect the USB.
- 3 Load a compact disc(Digital Audio).
 - ◆ Press the **OPEN/CLOSE** button to open the CD door.
 - ◆ Insert a CD and press the **OPEN/CLOSE** button to close the CD door.
 - ◆ Use the CD selection (**⏮** or **⏭**) buttons to select the desired song.
- 4 Press **CD RIPPING** button on remote control to starting ripping.
 - ◆ If the system is playing state, press this button, "TRACK RIPPING" is displayed and CD RIPPING starts.
 - ◆ If the system is playing state, press and hold this button, "FULL CD RIPPING" is displayed and CD RIPPING starts.
 - ◆ During CD ripping, do not disconnect USB device.
- 5 To stop ripping, press **STOP**(**⏹**)button.and then automatically create and save as the MP3 file.
After CD-Ripping,a directory named "RIPPING FOLDER" will be created in your device, and the file name is same with the disc.

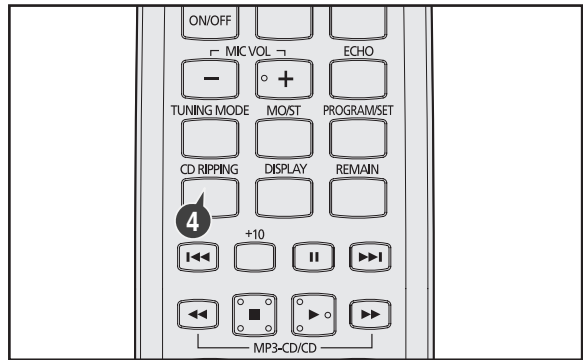
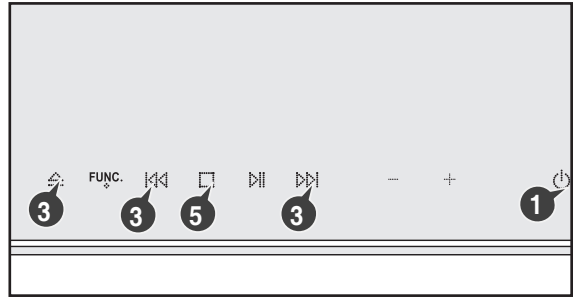

Note

- ◆ Don't disconnected USB and AC Cord during CD-Ripping. This may cause the file damage. If you want to stop CD-Ripping during CD-Ripping, you must press stop key first and after the CD Stopped, then you can remove the USB device.
- ◆ If you disconnected USB device when CD Ripping, the main unit will be power off and you may not delete the ripped file. In this case, please connect the USB on the PC and backup the USB data on the PC first and then formate the USB device.
- ◆ When the USB memory is not enough, it will be displayed "RIPPING ERROR".
- ◆ With external HDD, FAT format the USB can be CD Ripping, but not NTFS. The CD Ripping function of this product does not support all USB devices.
- ◆ When you use CD high speed search function or in the Pause or Stop mode, the CD Ripping can't work.
- ◆ During CD Ripping, do not deal impact. If is shocked while CD Ripping, CD Ripping maybe disengage.
- ◆ Sometimes, some of USB devices, CD Ripping time is long.
- ◆ In program mode, you can't use CD RIPPING function.

Timer Function

The timer enables you to switch the system on or off at specific times.

- If you no longer want the system to be switched on or off automatically, you must cancel the timer.
- 👉 ♦ Before setting the timer, check that the current time is correct.
- ♦ For each step, you have a few seconds to set the required options. If you exceed this time, you must start again.

- 1 Switch the system on by pressing **POWER**.
- 2 Press **TIMER/CLOCK** thrice, **TIMER** is displayed.
- 3 Press **PROGRAM/SET**.
Result: **TIME ON** is displayed for a few seconds, followed by any switch-on time already set; you can set the timer switch-on time.
- 4 Set the timer switch-on time.
 - a Press the **TUNING** \wedge or \vee buttons.
 - b Press **PROGRAM/SET**.
Result: The minutes flash.
 - c Press the **TUNING** \wedge or \vee buttons.
 - d Press **PROGRAM/SET**.
Result: **TIME OFF** is displayed for a few seconds, followed by any switch-off time already set, you can now set the timer switch-off time.
- 5 Set the timer switch-off time.
 - a Press the **TUNING** \wedge or \vee buttons.
 - b Press **PROGRAM/SET**.
Result: The minutes flash.
 - c Press the **TUNING** \wedge or \vee buttons.
 - d Press **PROGRAM/SET**.
Result: **VOL XX** is displayed, where **XX** corresponds to the volume already set.
- 6 Press **TUNING** \wedge or \vee to adjust the volume level and press **PROGRAM/SET**.
Result: The source to be selected is displayed.
- 7 Press the **TUNING** \wedge or \vee buttons to select the source to be played when the system switches on.

If you select...	You must also...
TUNER (radio)	a Press PROGRAM/SET . b Select a preset station by press the TUNING \wedge or \vee buttons.
CD (compact disc)	Load disc.
USB	connect usb.

- 8 Press **PROGRAM/SET** to confirm the timer.

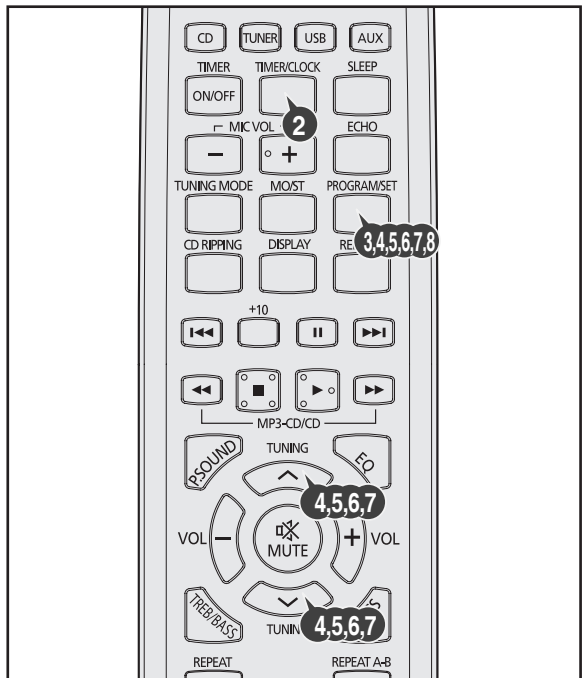
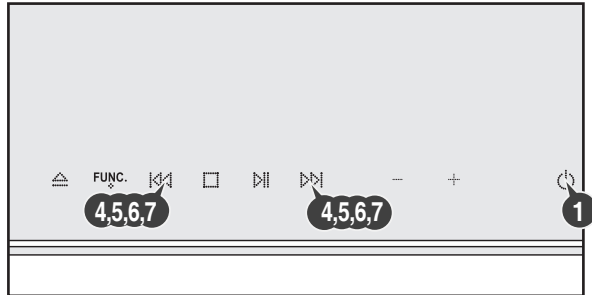

Cancelling the Timer

After having set the timer, it will start automatically as shown by the **TIMER** indication on the display. If you no longer wish to use the timer, you must cancel it.

To...	Press TIMER ON/OFF ...
Cancel the timer	Once. Result: TIMER is no longer displayed.
Restart the timer	Twice. Result: TIMER is displayed again.

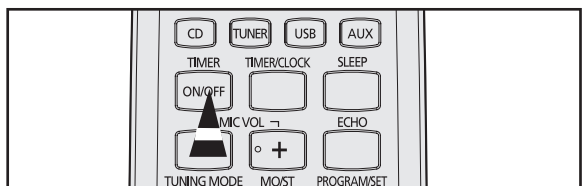

- ♦ If the timer switch on and off times are identical, the word **ERROR** is displayed.
- ♦ You may use \ll or \gg buttons on the main unit to instead of the **TUNING** \wedge or \vee buttons to adjust in step 4, 5, 6, 7.

Mute Function

You can turn the sound off temporarily on your system.

Example: You wish to answer a telephone call.

- 1 Press **MUTE**.
- 2 To switch the sound back on, press **MUTE** again or the **VOLUME** buttons.

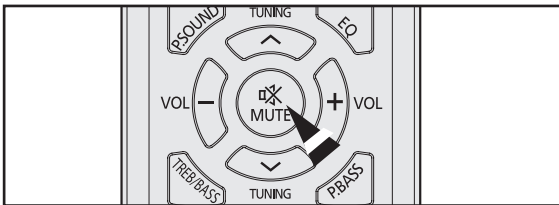

Selecting EQ Mode

Your micro-compact system is equipped with a preset equalizer that allows you to choose the most appropriate balance between treble and bass frequencies, according to the type of music you are listening to.

- 1 Press the **EQ** button.
Each time the button is pressed, the selection changes as follows:
PASS → ROCK → JAZZ → POP → CLASSIC → DANCE → PARTY → HIP-HOP → DNSE → WIDE 3D

- **POP, JAZZ, ROCK** : Depending on the genre of music, you can select POP, JAZZ, and ROCK.
- **CLASSIC** : Select this when listening to classical music.
- **DANCE** : Simulates the sound of a dance club with a throbbing bass beat.
- **PARTY** : Provides the feeling of a party club.
- **HIP-HOP** : Provides a clear vocal as if listening HIP-HOP music.
- **DNSE** : Provides various sound settings to enhance the type of music you're listening to.
- **WIDE 3D** : Provides various sound settings to enhance the type of music you're listening to.
- **PASS** : Select this for normal listening.

- ▶ When you insert the microphone, you can't select DNSE and WIDE 3D modes.

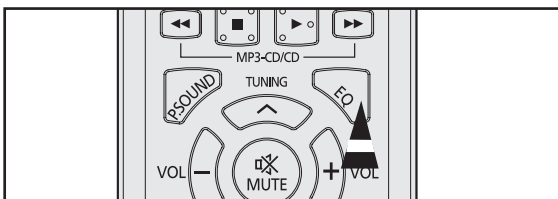

- When CD Ripping, the EQ function can't work and the EQ automatically covert to "PASS" mode.
- When CD Ripping, the P.SOUND, P.BASS function can't work and the P.SOUND, P.BASS automatically covert to "OFF" mode.

Treble Level Function

Treble Control function stresses high tones providing thudding soundeffects.

- 1 Press **TREB/BASS** button until **TREB 00** is displayed. Press **TUNING** \wedge or \vee button to select from **TREB -08** to **TREB 08**.
- 2 You can select the level of high tones you desire.

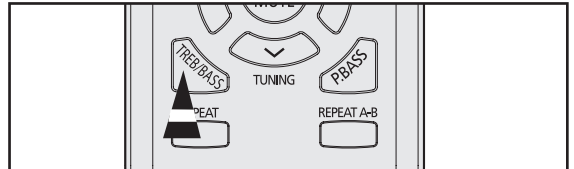

Bass Level Function

BASS function stresses low tones providing thudding sound effects.

- 1 Press **TREB/BASS** button until **BASS 00** is displayed. Press **TUNING** \wedge or \vee button to select from **BASS -08** to **BASS 08**.
- 2 You can select the level of low tones you desire.

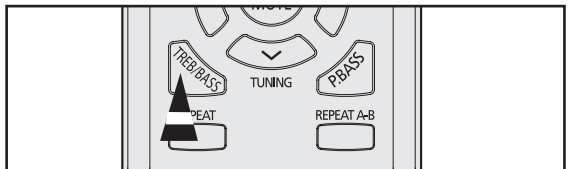

Power Sound Function

Your compact system is equipped with the function of **Power Sound**.

The function of **Power Sound** amplifies bass and improves highkey or bass twice as much for you to appreciate powerful realsound.

- 1 Press the **P.SOUND** button.
Result: "**P.SOUND**" is displayed.
- 2 To cancel this function, press **P.SOUND** again, "**OFF**" is displayed for a few seconds.

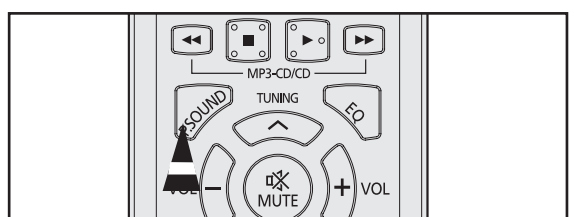

Power Bass Function

Your micro-compact system has a bass amplification function called SBS (Super Bass Sound). This function makes the sound more powerful and real.

- 1 Press the **P.BASS** button.
Result: "P. BASS" is displayed.
- 2 To cancel this function, press **P.BASS** again, "OFF" is displayed for a few seconds.

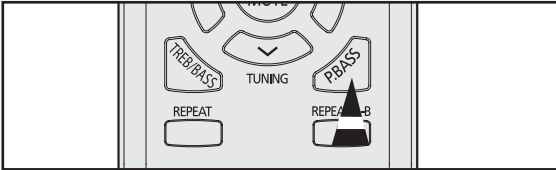

Setting the System to Switch off Automatically

While listening to music, you can set the system to switch off automatically.

Example: You wish to go to sleep to music.

- 1 Press **SLEEP**.
Result: playback starts and the following indications are displayed:
90 MIN
 - 2 Press **SLEEP** once or more times to indicate how long the system should continue playing before it switches off.
 - 90 MIN → 60 MIN → 45 MIN → OFF → 15 MIN → 30 MIN →
- At any time, you can:
- ◆ Check the remaining time by pressing **SLEEP**
 - ◆ Change the remaining time by repeating Steps 1 and 2
- 3 To cancel SLEEP function, press **SLEEP** once or more times until **OFF** is display.

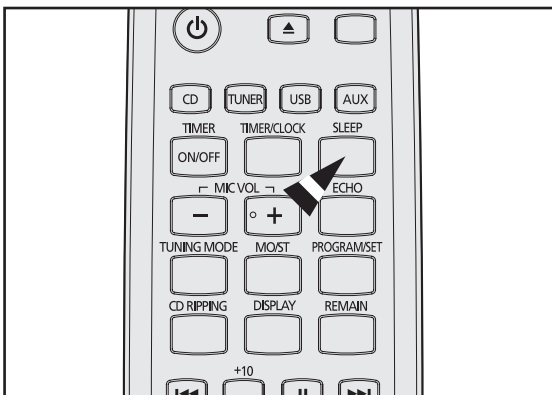

Connecting Headphones

You can connect a set of headphones to your micro-compact system so that you can listen to music or radio programmers without disturbing other people in the room. The headphones must have a 3.5ø jack or an appropriate adapter.

Connect the headphones to the **PHONES** jack on the main unit.
Result: The loudspeakers are no longer used to output the sound.

- ⚠ Prolonged use of headphones at a high volume may damage your hearing.

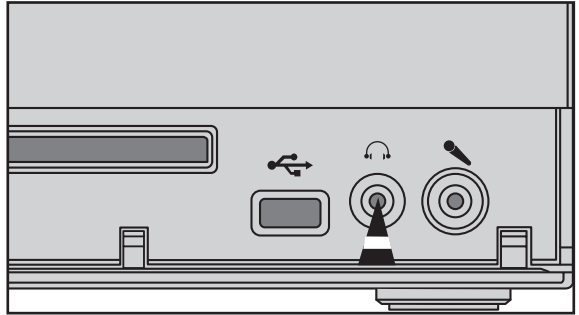

Connecting Microphone

You can also insert microphone to sing along with your favorite CD.

- ⚠ Plug a microphone with a 3.5ø MIC jack into the Mic terminal.
- Connect one Microphone.
- Press the **MIC VOL** button to adjust the **MIC** volume.
- Press the **ECHO** button to select ECHO1, ECHO2, and ECHO OFF.

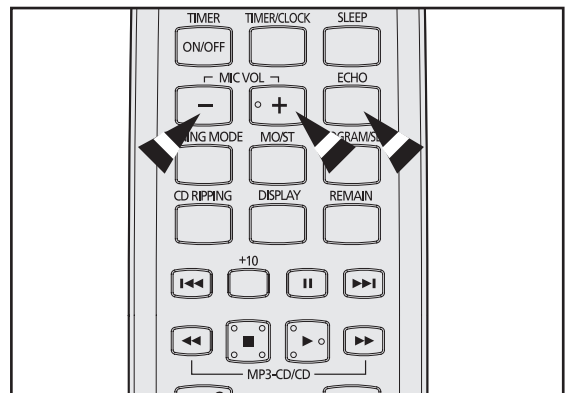
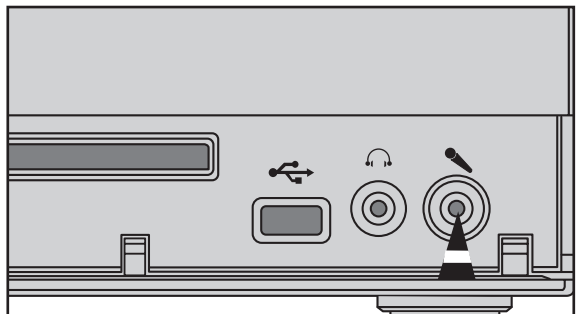

Safety Precautions

The following diagrams illustrate the precautions to be taken when using or moving your micro-compact system.

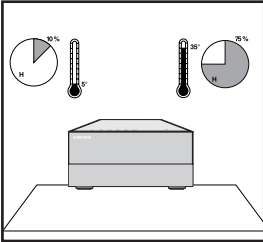

Ambient operating conditions:
 Ambient temperature +41°F-95°F
 Humidity 10-75%

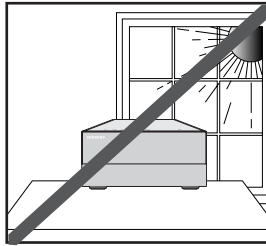

Do not expose the unit to direct sun radiation or other heat sources. This could lead to overheating and malfunction of the unit.

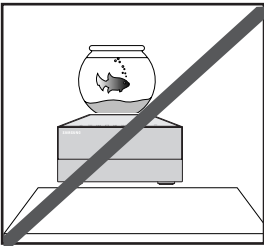

Do not place potted plants or vases on top of the unit. Moisture entering the unit could lead to dangerous electric shock and can cause equipment damage. In such events immediately disconnect the main plug from the socket.

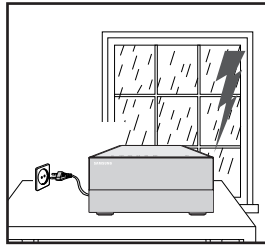

During thunderstorms, disconnect the main plug from the socket. Main voltage peaks due to lightning could damage the unit.

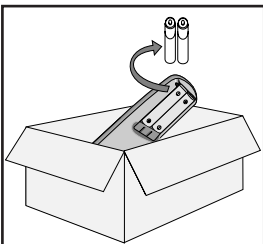

Remove the batteries from the remote control, if not used for any extended period. Leaking batteries can cause serious damage to the remote control.

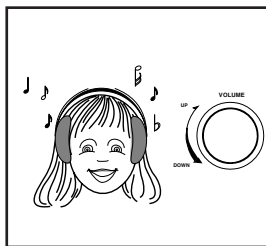

When using headphones, take care not to listen at excessive volumes. Extended use of headphones at high volumes will lead to hearing damage.

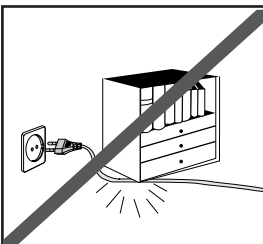

Do not place heavy items on the main lead. Main cable damage can lead to damage of the equipment (fire hazard) and can cause electric shock.

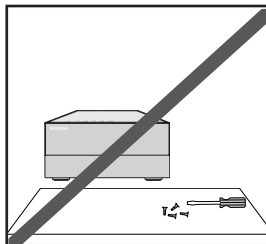

Do not remove any equipment panels. The inside of the unit contains live components, which cause electric shock.

Cleaning Your Micro-Compact System

To obtain the best possible results from your micro-compact system, you must clean the following elements regularly:

- ◆ The outer casing
- ◆ The compact disc player
- ◆ The cassette players (heads, rollers and drive capstans)

- ◆ Always unplug the system from the wall outlet:
 - ◆ Before cleaning it
 - ◆ If you are not going to be using it for a long time

Outer Casing

Clean the outer casing regularly using a soft cloth and a light detergent. Do not use abrasive powders, liquids or aerosol cleaners. Never let any liquids get into the system.

Compact Disc Player

- 1 Before playing a compact disc, clean it with a special CD cleaning agent. Do not use the same cleaning agents as for vinyl LP records. Carefully wipe the disc from the center outward.
- 2 Regularly clean the player with a special cleaning disc (available from your local dealer).
 - ◆ If you will not be using the remote control for a long time, remove the batteries to prevent corrosion.
 - ◆ Although your system is very hard-wearing, it should not be used in an excessively dusty environment or subjected to shocks or extreme heat (close to heating appliances or in direct sunlight, etc.).
 - ◆ If the unit emits an unpleasant odor when in use, unplug it from the main supply and contact the after-sales service.

Precautions When Using Compact Discs

- ◆ Handle your compact discs with care. Always hold them by the edges to avoid leaving fingerprints on the shiny surface.
- ◆ When you have finished playing a compact disc, always put it back in its case.
- ◆ Do not fix paper or adhesive tape to the discs and do not write on the label.
- ◆ Clean them with a special-purpose cloth.
- ◆ Store your compact discs in a clean place, out of direct sunlight, where they will not be exposed to high temperatures.
- ◆ Always use compact discs marked 

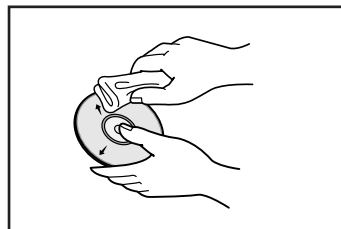

Before Contacting the After-Sales Service

If it always takes a little time to become familiar with a new appliance. If you have any of the problems listed below, try the solutions given. They may save you the time and inconvenience of an unnecessary service call.

If the above guidelines do not allow you to solve the problem, take a note of:

- ◆ The model and serial numbers, normally printed on the rear of the system
- ◆ Your warranty details
- ◆ A clear description of the problem

Then contact your local dealer or SAMSUNG after-sales service.

Problem	Checks/Explanation
<p>The system does not work</p>	<ul style="list-style-type: none"> • The main lead is not correctly plugged into a wall socket or the wall socket is not switched on. • The remote control batteries need replacing or the polarity has not been respected. • The POWER button has not been pressed.
<p>G E N E R A L</p> <p>There is no sound</p>	<ul style="list-style-type: none"> • The volume has been completely turned down. • The correct function (TUNER, CD, USB, AUX) has not been selected. • You have connected a set of earphones. • The loudspeaker wires have been disconnected. • The MUTE button has been pressed.
<p>The Timer does not work</p>	<ul style="list-style-type: none"> • The timer has been stopped by pressing TIMER ON/OFF.
<p>In case it does not work, even the action is taken as above.</p>	<ul style="list-style-type: none"> • Press the STOP button on the remote control for 5 seconds in power 'OFF'(standby), then it is returned the original position (RESET).
<p>CD / MP3 I CD</p> <p>The compact disc player does not start playing</p>	<ul style="list-style-type: none"> • The CD function has not been selected. • The disc has been inserted face down or is either dirty or scratched. • The laser sensor is dirty or dusty. • The system has not been installed on a flat, horizontal surface. • Condensation has formed in the player; leave the system in a warm, airy room for at least one hour.
<p>R A D I O</p> <p>Reception is poor or no radio stations are received at all</p>	<ul style="list-style-type: none"> • The TUNER function has not been selected. • The radio frequency has not been correctly selected. • The aerial has been disconnected or is not facing the right way. Turn it until you find the best orientation. • You are in a building that blocks radio waves; you must use an outside aerial.

Technical Specifications

ENG

SAMSUNG strives to improve its products at all times. Both the design specifications and these user instructions are thus subject to change without notice.

RADIO

FM

Signal/noise ratio	55 dB
Usable sensitivity	12 dB
Total harmonic distortion	0.5 %

COMPACT DISC PLAYER

Capacity	1 disc
Frequency range	20 Hz - 20 KHz (± 1 dB)
Signal/noise ratio	90 dB (at 1 KHz) with filter
Distortion	0.05 % (at 1 KHz)
Channel separation	60 dB
Disc sizes	Diameter: 5 or 3 1/2 inches. Thickness: 0.05inches

AMPLIFIER

Output power	
Front Speaker (8 Ω)	60 Watts/CH X2 RMS,IEC (total harmonic distortion: 10 %)
Channel separation	60 dB
Signal/noise ratio	70 dB

GENERAL

Power Consumption	40W
Dimensions	9.1 (W) x 3.9(H) x 9.5 (D) inches
Weight	4.2 lbs

LIMITED WARRANTY TO ORIGINAL PURCHASER

Samsung Electronics Canada Inc.(SECA), warrants that this product is free from defective material and workmanship.

SECA further warrants that if this product falls to operate properly within the specified warranty period and the failure is due to improper workmanship or defective materials, SECA will repair or replace the product at its option.

All warranty repairs must be performed by a SECA Authorized Service Center. (The name and address of the location nearest you can be obtained by calling toll free: 1- 800- SAMSUNG)

LABOR

One year (Carry- in)

PARTS

One year

On carry-in models, transportation to and from the service center is the customer's responsibility.

The original dated sales receipt must be retained by the customer and is the only acceptable proof of purchase. It must be presented to the authorized service center at the time service is requested.

EXCLUSIONS (WHAT IS NOT COVERED)

This warranty does not cover damage due to accident, fire, flood and/ or other acts of God; misuse, incorrect line voltage, improper installation, improper or unauthorized repairs, commercial use or damage that occurs in shipping. Exterior and interior finish, lamps, glass are not covered under this warranty. Customer adjustments which are explained in the instruction manual are not covered under the terms of this warranty. This warranty will automatically be voided for any unit found with a missing or altered serial number. This warranty is valid only on products purchased and used in Canada.

**HEADQUARTERS
SAMSUNG ELECTRONICS CANADA INC.,
CUSTOMER SERVICE
55 STANDISH COURT MISSISSAUGA, ONTARIO L5R 4B2 CANADA
FABRIQUE EN CORÉE
1-800-SAMSUNG (1-800-7267864)
WWW.SAMSUNG.COM/CA**

Contact SAMSUNG WORLD WIDE

If you have any questions or comments relating to Samsung products, please contact the SAMSUNG customer care center.

Region	Country	Customer Care Center ☎	Web Site
North America	CANADA	1-800-SAMSUNG (726-7864)	www.samsung.com/ca
	MEXICO	01-800-SAMSUNG (726-7864)	www.samsung.com/mx
	U.S.A	1-800-SAMSUNG (726-7864)	www.samsung.com/us
Latin America	ARGENTINE	0800-333-3733	www.samsung.com/ar
	BRAZIL	0800-124-421, 4004-0000	www.samsung.com/br
	CHILE	800-SAMSUNG (726-7864)	www.samsung.com/cl
	NICARAGUA	00-1800-5077267	www.samsung.com/latin
	HONDURAS	800-7919267	www.samsung.com/latin
	COSTA RICA	0-800-507-7267	www.samsung.com/latin
	ECUADOR	1-800-10-7267	www.samsung.com/latin
	EL SALVADOR	800-6225	www.samsung.com/latin
	GUATEMALA	1-800-299-0013	www.samsung.com/latin
	JAMAICA	1-800-234-7267	www.samsung.com/latin
	PANAMA	800-7267	www.samsung.com/latin
	PUERTO RICO	1-800-682-3180	www.samsung.com/latin
	REP. DOMINICA	1-800-751-2676	www.samsung.com/latin
	TRINIDAD & TOBAGO	1-800-SAMSUNG (726-7864)	www.samsung.com/latin
VENEZUELA	0-800-100-5303	www.samsung.com/latin	
COLOMBIA	01-8000112112	www.samsung.com.co	
Europe	BELGIUM	02 201 2418	www.samsung.com/be (Dutch) www.samsung.com/be_fr (French)
	CZECH REPUBLIC	800-SAMSUNG (800-726786)	www.samsung.com/cz
	DENMARK	8-SAMSUNG (7267864)	www.samsung.com/dk
	FINLAND	30-6227 515	www.samsung.com/fin
	FRANCE	01 4863 0000	www.samsung.com/fr
	GERMANY	01805-SAMSUNG (726-7864 € 0,14/Min)	www.samsung.de
	HUNGARY	06-80-SAMSUNG (726-7864)	www.samsung.com/hu
	ITALIA	800-SAMSUNG (726-7864)	www.samsung.com/it
	LUXEMBURG	02 261 03 710	www.samsung.com/lu
	NETHERLANDS	0900-SAMSUNG (0900-7267864) (€ 0,10/Min)	www.samsung.com/nl
	NORWAY	3-SAMSUNG (7267864)	www.samsung.com/no
	POLAND	0 801 1SAMSUNG (172678), 022-607-93-33	www.samsung.com/pl
	PORTUGAL	80820-SAMSUNG (726-7864)	www.samsung.com/pt
	SLOVAKIA	0800-SAMSUNG (726-7864)	www.samsung.com/sk
	SPAIN	902-1-SAMSUNG (902 172 678)	www.samsung.com/es
	SWEDEN	0771 726 7864 (SAMSUNG)	www.samsung.com/se
	U.K	0845 SAMSUNG (7267864)	www.samsung.com/uk
	EIRE	0818 717 100	www.samsung.com/ie
	AUSTRIA	0810-SAMSUNG (7267864, € 0.07/min)	www.samsung.com/at
SWITZERLAND	0848-SAMSUNG (7267864, CHF 0.08/min)	www.samsung.com/ch	
CIS	RUSSIA	8-800-555-55-55	www.samsung.ru
	KAZAKHSTAN	8-10-800-500-55-500	www.samsung.com/kz_ru
	UZBEKISTAN	8-10-800-500-55-500	www.samsung.com/kz_ru
	KYRGYZSTAN	00-800-500-55-500	
	TADJIKISTAN	8-10-800-500-55-500	
	UKRAINE	8-800-502-0000	www.samsung.ua
	BELARUS	810-800-500-55-500	www.samsung.com/lt
	MOLDOVA	00-800-500-55-500	
	LITHUANIA	8-800-77777	
	LATVIA	8000-7267	www.samsung.com/lv
ESTONIA	800-7267	www.samsung.com/ee	
Asia Pacific	AUSTRALIA	1300 362 603	www.samsung.com/au
	NEW ZEALAND	0800 SAMSUNG (0800 726 786)	www.samsung.com/nz
	CHINA	400-810-5858, 010-6475 1880	www.samsung.com/cn
	HONG KONG	3698-4698	www.samsung.com/hk
	INDIA	3030 8282, 1800 110011, 1800 3000 8282	www.samsung.com/in
	INDONESIA	0800-112-8888	www.samsung.com/id
	JAPAN	0120-327-527	www.samsung.com/jp
	MALAYSIA	1800-88-9999	www.samsung.com/my
	PHILIPPINES	1-800-10-SAMSUNG (726-7864), 1-800-3-SAMSUNG (726-7864), 1-800-8-SAMSUNG (726-7864), 02-5805777	www.samsung.com/ph
	SINGAPORE	1800-SAMSUNG (726-7864)	www.samsung.com/sg
	THAILAND	1800-29-3232, 02-689-3232	www.samsung.com/th
TAIWAN	0800-329-999	www.samsung.com/tw	
VIETNAM	1 800 588 889	www.samsung.com/vn	
Middle East & Africa	TURKEY	444 77 11	www.samsung.com/tr
	SOUTH AFRICA	0860-SAMSUNG (726-7864)	www.samsung.com/za
	U.A.E	800-SAMSUNG (726-7864), 8000-4726	www.samsung.com/ae

